

TR 30837
 OFFSITE STORM DRAIN/SEWER IMPROVEMENTS
 PROPOSED DETOUR PLAN FOR
 WASHINGTON ST. CLOSURE
 BETWEEN BENTON RD. AND ABELLIA ST.

NOT TO SCALE

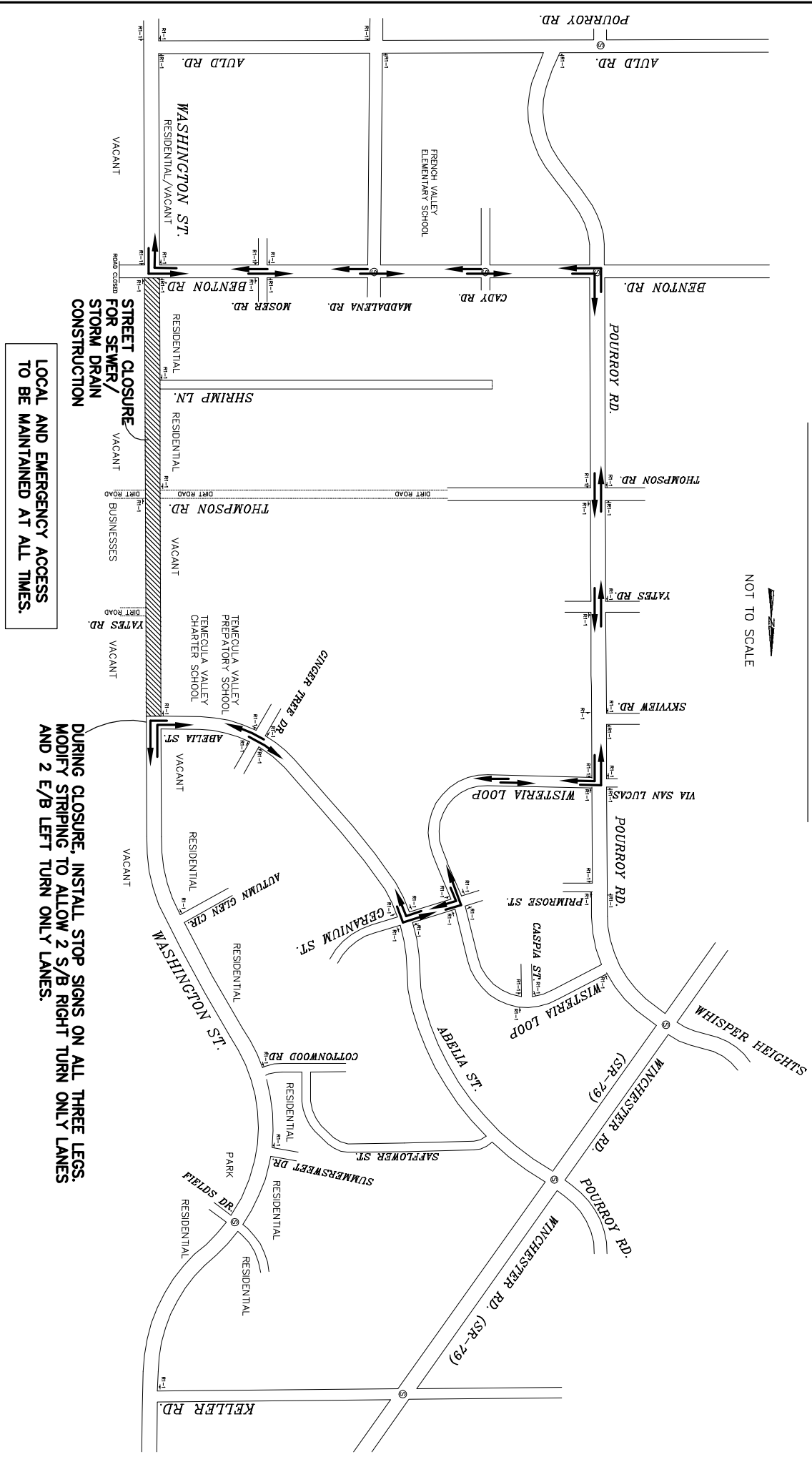

LOCAL AND EMERGENCY ACCESS
 TO BE MAINTAINED AT ALL TIMES.

DURING CLOSURE, INSTALL STOP SIGNS ON ALL THREE LEGS.
 MODIFY STRIPING TO ALLOW 2 S/B RIGHT TURN ONLY LANES
 AND 2 E/B LEFT TURN ONLY LANES.